

# Moorings 42.1

## Specifications and Equipment List - Moorings Upgrades In Bold

### DECK & HULL

---

- Design in accordance with European Directive requirements and according to EC certification
- Monolithic hull in polyester
- Monolithic structural hull liner bonded to the hull
- Injection molded deck in glass fiber/balsa sandwich, covered with diamond-point non-slip coating
- Cast iron keel fixed with bolts and stainless steel backing plates
- **White hull with Moorings graphics**
- **Shoal keel**
- Rudder hung with glass compound stock
- Self-bailing chain locker - Clench bolt - Hatch cover
- 6 Aluminum mooring cleats - Stainless steel deck line protection
- 1 Open stainless steel forward pulpit
- 2 Stainless steel aft pushpits
- **Double stainless steel lifelines uncoated and stainless steel stanchions - Access to port and starboard in lifelines**
- Horseshoe buoy with holder
- **Manual, fully opening transom with gas cylinder assist, convertible into swim platform with natural solid wood decking with retrieval line (2,76 m x 0,74 m / 9ft 1in x 2ft 5in)**
- **1 Stainless steel integrated telescopic swimming ladder and backing plate with stainless steel protection**
- **1 Outboard engine bracket**
- 1 x Flag pole holder (stainless steel)
- **1000w Electric windlass with 10mm gypsey and hand control wired direct & cockpit chain counter**
- **Double stemhead anchor roller**
- Emergency ladder (Pushpit)
- **Transom protection**

### COCKPIT & COMPANIONWAY

---

- Self-bailing cockpit
- 1 Locker (to port)
- 2 Lockers in cockpit floor under helm's feet
- 1 Liferaft locker to starboard
- **2 Gas lockers for 10lb propane bottles**
- **Natural solid wood slatted cockpit benches**
- 2 Steering wheel consoles: Stainless steel steering wheels - 900 mm diameter - Steering gear at the helm station - Metal cable transmission system - Stainless steel handrail - Fixed navigation instrument pod - Glass holder
- 1 Deck filler for access to tiller system
- 1 Emergency tiller
- 2 Steering compasses on consoles
- Portside engine control and control panel
- Cockpit table, stainless steel structure, 2 leaves, Cup holders
- 1 Mainsail arch (fixed, Composite, Built-in lighting)
- 2 Hinged PMMA companionway doors - Sliding hatch made of PMMA
- **Wooden salon companionway with molded wood hanging steps with molded non-slip surface**
- **Hanging light in cockpit**
- **Natural solid wood slatted helm seats**
- **Hasp on companionway hatch**
- **Bimini & dodger**

### MAST, RIGGING & SAILS

---

- **Custom heavy duty battened charter mainsail**
- **Custom heavy duty charter furling genoa with Moorings blue UV protection strips**
- **Stackpack lazy bag with Moorings logo**
- Mast 9/10 anodized aluminum installed on the deck, 2 sets of spreaders
- Anodised aluminium boom
- Discontinuous (stainless steel) standing rigging
- 2 Backstay: Bridle
- Rigid boom vang
- **Genoa Profurl furling system with drum on the deck**
- 1 Stand-Up block for mainsail on fixed composite arch
- 2 Genoa tracks with piston adjusted traveller cars
- 2 Genoa sheet return blocks

- Rigging run back to cockpit (except boom topping lift)
- Complete running rigging: Main halyard, Genoa halyard with clutch on mast and cleat, Boom topping lift with cleat on mast, Mainsheet, 2 Genoa sheets 2 Reefing lines
- 6 Line stoppers
- 2 Self-tailing genoa sheet winches (H46.2 STA)
- 1 Self-tailing halyard winch (H40.2 STA), starboard
- 2 Aluminum winch handles
- 2 Winch handle holders
- **Alloy sheaves & gooseneck bushing**
- **Protection guard on steaming light**
- **Windex wind vane**

## SALOON/INTERIOR

---

- **Light satin oak interior**
- **Faux leather saloon cushions**
- **Saloon table converts to a double berth**
- Parquet type laminated floors
- U-shaped salon seating and additional bench with backrest - in double density foam
- Salon Headroom: 1,93 m / 6ft 4in
- Salon table, 1 folding leaf - Varnished wooden top - Central and side storages, Bottle holder
- Mirror on bulkhead
- Storage under bench seats
- 2 Coachroof panoramic windows
- 2 Hull portholes
- 1 Opening and 1 secured porthole on coaming in side windows
- 1 Opening deck hatch
- **Mosquito screens for portlights**
- **Wine bottle holder below floor**

## NAVIGATION CONSOLE

---

- Chart table storage beneath hinged top - Molded wood beading
- Switch panel on bulkhead for access to electrical functions
- 1 Reading light

## GALLEY

---

- Galley Headroom: 1,94 m / 6ft 4in
- L-shaped galley
- Compact grey laminated worktop
- 1 Stainless steel sink 1 rectangular basin - 1 Mixer tap cold water / hot water, under pressure
- 1 Gas stove 2 burners - Stainless steel oven on gimbal mountings - Stainless steel protection handrail
- Storage space along the hull
- **1 190 L ice box / 50 US Gal, top and front opening + Freezer (10 L / 3USGal )**
- Fitted cupboards and closed cubbyholes - Garbage bin
- 1 Lower cupboard: 2 Drawers, 1 Storage
- 1 Opening portlight in side windows in the coaming
- **Propane solenoid valve**

## AFT HEAD

---

- Head -- Starboard Aft -- Headroom: 1,85 m / 6ft 1in
- Access through salon and the starboard aft cabin
- Separate shower - 1 Mixing tap hot water / Cold water
- **PMMA shower screen**
- Sink - 1 mixing tap hot/cold water
- Washroom cabinet
- 2 Mirrors
- Toilet accessories
- 1 Opening portlight in side windows in the coaming
- **Large bowl Quiet Flush electric marine toilet with individual holding tank**

## STARBOARD AFT CABIN

---

- Headroom: 1,92 m / 6ft 4in
- 1 Double bed (2,07 x 1,47 x 1,11 m / 6ft 9in x 4ft 10in x 3ft 10in)
- Access door to starboard aft washroom
- Hanging locker - Open cubbyholes
- 1 Bed access sideboard

- 1 Hull porthole
- 1 Cockpit window
- 1 Porthole opening onto cockpit
- 1 Flush deck hatch
- **Grey covered foam mattress**

## PORT AFT CABIN

---

- Headroom: 1,92 m / 6ft 4in
- Double bed - Port cabin (2,07 x 1,32 x 1,10 m / 6ft 9in x 4ft 4in x 3ft 7in)
- 1 Bed access sideboard
- Cupboard - Hanging locker - Closed cubbyholes
- 1 Hull porthole
- 1 Cockpit porthole with curtain
- 1 Flush deck hatch
- 1 Cockpit window
- **Grey covered foam mattress**

## FORWARD CABIN

---

- Headroom: 1,88 m / 6ft 2in
- Double bed (2,12 x 1,50 x 1,25 m / 6ft 11in x 4ft 11in x 4ft 1in )
- **Grey covered foam mattress**
- 1 Cupboard: ½ Hanging locker, ½ Shelves
- 1 Storage space under bed
- Open storage compartment along the hull
- 1 Closed locker
- 2 Opening hatches
- 2 Hull portholes

## FORWARD HEAD

---

- Headroom: 1,81 m / 5ft 11in
- Access through forward cabin
- Moulded basin - mixing tap hot/cold water
- 1 Mirror
- 1 Washroom cabinet
- Toilet accessories
- Cupboard
- 1 Opening porthole on roof
- **Large bowl Quiet Flush electric marine toilet with individual holding tank**

## ENGINE & CONTROLS

---

- **Yanmar 3JH45 -- 45 hp common rail diesel with sail drive**
- 1 Rotomoulded diesel tank 200 L / 53 US Gal (under port aft berth) - Electronic gauge - Low level alarm - 1 Deck filler
- Engine control - Control panel in cockpit
- Engine compartment: Soundproofing foam - Ventilation: 1 air intake and 1 air outlet
- 1 Alternator 12v / 125 Amp
- Filters: Sea water - Diesel - Water separator
- Fixed three blade propeller
- 1 Engine access through companionway (opening with 2 gas pistons) - 2 Engine access through aft cabins

## PLUMBING INSTALLATION

---

- 1 Rotomolded freshwater tank (240 L / 63 US Gal Forward cabin) - 1 Deck filler
- **Additional 330L / 87USgal water tank**
- Waterpressure system - Expansion tank - Inline filter
- Automated shower drains
- 1 Electric bilge pump - 1 Manual bilge pump
- **Quick 40 L / 11 Gal Water Heater**
- **Hot & cold transom shower**

## ELECTRICAL INSTALLATION

---

- 12v circuit for house and engine systems, 12v plugs at nav station, 110/220v plugs in each cabin, saloon, chart table and galley
- 12v Electrical panel (Fuses - Voltmeter - Water gauge - Fuel gauge - Battery warning - Fuel warning - Water warning)
- 1 x 12v Power outlet
- **LED lights throughout**
- **LED navigation and anchoring lights**

- Wire runs for optional cables
- 2 Fixed shore power cables
- **Fans in saloon and all cabins**
- **2 x USB ports in each cabin**
- **Fusion 700i Radio / Mp3 player + 2 interior speakers + 2 cockpit speakers**
- **TV/DVD and bracket in the saloon**
- **Shore power Air Conditioning**
- 1 x 110ah Lead acid engine battery
- **House battery bank -- 4 Dryfit gel batteries totalling 340ah**
- **Battery charger 60amp**
- **12" Multifunction touchscreen display in cockpit with fixed pod (WIFI enabled)**
- **1 x Tridata**
- **1 x Autopilot control head**
- **Hydraulic linear drive autopilot**
- **Depth sounder & anemometer windvane**
- **VHF with AIS (receiving only)**
- **Flush mounted solar panels totalling 150w with charge controller**
- **Moorings marine smarthub (wifi via cellular network and stored local content)**

## SAFETY GEAR

- **Primary (stainless steel) and secondary (galvanized) anchors**
- **6 x Fenders**
- **6 x Mooring / dock lines**
- **Lifejackets and safety harnesses per max pax**
- **Bell**
- **Flare kit**
- **Binoculars**
- **Navigation tools: Parallel rule, compass, dividers**

## CRUISING GEAR

- **Bed linens per max pax**
- **Plates, cups, saucers, glasses per max pax**
- **Flatware per max pax**
- **Pots, pans, miscellaneous food prep tools**
- **Cooking utensils**
- **Coffee pot, tea, kettle, toaster**
- **Snorkeling gear per max pax**
- **Towels and washcloths per max pax**
- **Cockpit cushions per max pax**

Length Overall:	12.43m/40ft 9in
Waterline Length:	11.37m/37ft 4in
Beam:	4.20m/13ft 9in
Draft:	1.68m/5ft 6in
Displacement:	7836kg/17271lb
Fuel Capacity:	200L/53gal
Water Capacity:	570L/150gal
Engine:	Yanmar 45 HP

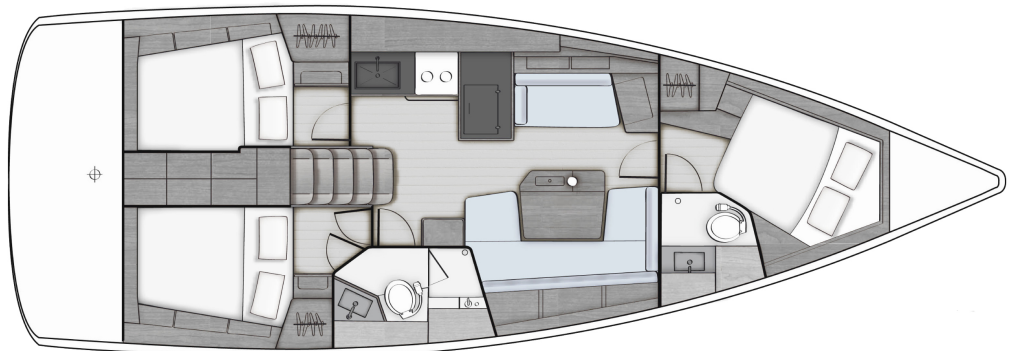

*The Builder reserves the right to change or amend the contents of this document at any time without prior notification to any third party, and no liability will be accepted for errors contained within the same.*